

# AERIAL JIB 2

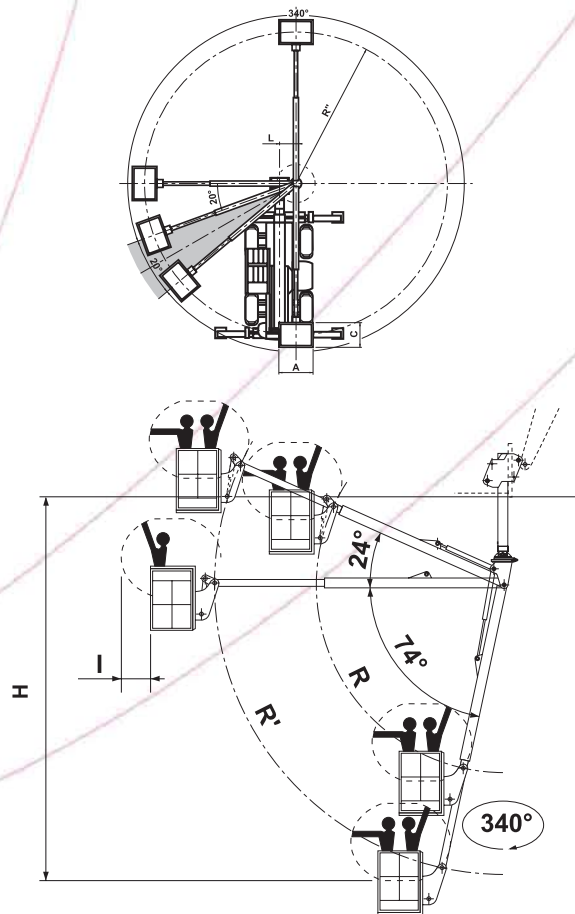
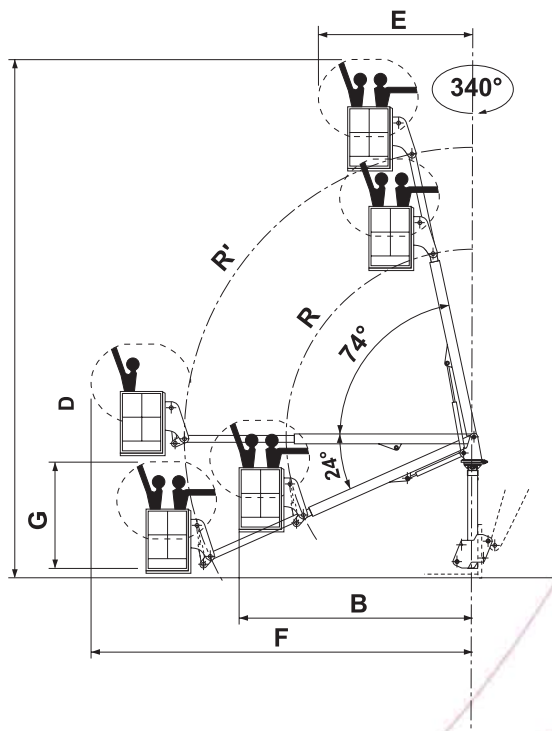

## Description:

Personnel platform with 90° + 90° rotation assembled on a telescopic boom (closed: 4,5 m; open: 6,8 m). The boom is equipped with a turntable that allows the platform to turn 340° without moving the machine. The attachments can be connected in two positions: one increases the range of the machine by 10 m in height, whereas the other allows the machine to work below ground level.

## Specifications:

- Maximum load: **200 Kg**
- Maximum number of people: 2.
- Platform dimension: **1,1 m x 0,8 m**
- 340° hydraulic rotation.

## Safety features:

- Boom position sensor

## CHARACTERISTICS

DESCRIPTION	LOAD LIMIT	OVERALL LENGTH													WEIGHT
		A	B	C	D	E	F	G	H	I	L	R	R'	R''	
AERIAL JIB 2	200 KG	1120	4468	800	9930	3210	6810	2000	6440	600	490	3300	5100	5810	1100 KG